



# DICGU ELECTRONICS CO.,LTD.

## VS011 Series SWITCH ( Voltage select Switches )



**VS011-5 series**

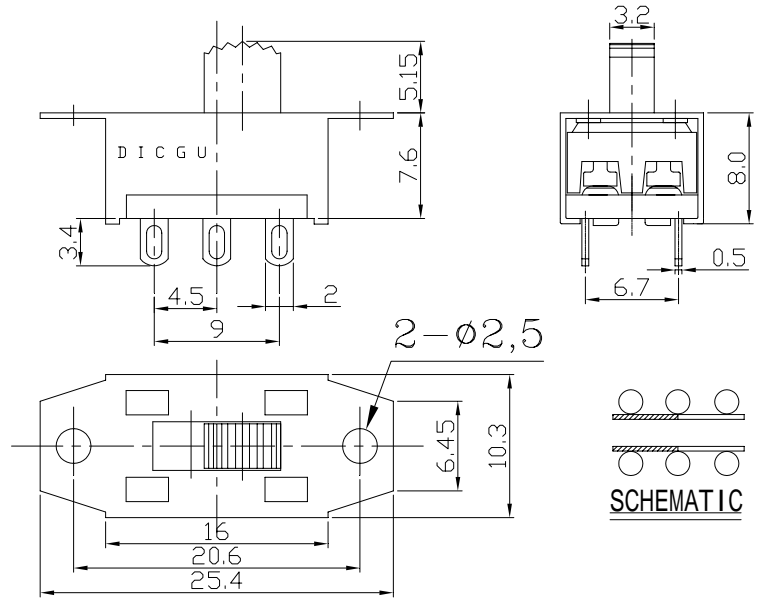
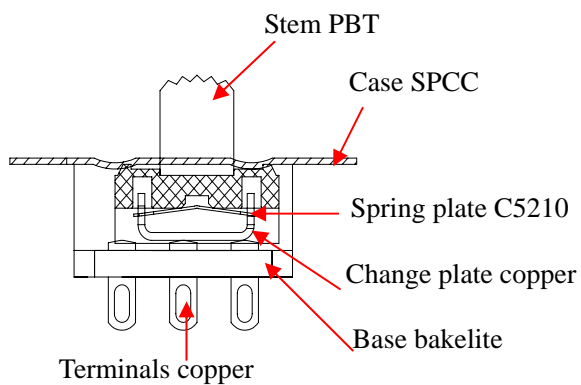

**VS011-5-01N-22**

### SPECIFICATIONS

Mechanical life: 100,000 cycles min

Contact rating: 3Amps@250vac; CUL, UL 6000  
6Amps@125vac; CUL, UL 6000;

Insulation resistance: > 500MΩ DC500V

Withstand Voltage: AC1500V 1 minute

Contact Resistance: < 50m

Operating Temper.: -25 to 65

Operating Force: 500±200gf